

Better
Homes
and Gardens®

SPECIAL INTEREST PUBLICATIONS.

Remodeling

Ideas for Your Home™

reveal
the
charm

how to update every room

special issue
trends
you'll
love
p. 73

94 pages of
inspiring solutions
15 budget savers
pro chefs'
home kitchen

June/July 2003

Display until July 15

\$4.99 US.



www.bhg.com
AOL Keyword: BHG

outdoor inspiration



above: Artistic rounded ends on the pavilion crossbeams give stylish form to the straight-line structure.

opposite: Enveloped by greenery, the pavilion in Lynn Smith's yard functions as a fresh-air sanctuary. A spacious teak table with cushioned teak seats provides a comfortable spot for outdoor meals and gatherings.

dining out

A backyard pavilion satisfies an appetite for alfresco dining and casual living.

Indianapolis designer Lynn Smith doesn't limit his definition of "home" to the spaces between walls covered by a roof. His idea of comfortable living extends into his backyard, where he enjoys a pool, patio, and even an outdoor dining pavilion.

When Lynn purchased his home, his primary goal was to rework the interiors, but once the in-house remodeling projects were complete, he turned to the yard. It was in dire need of a renaissance. Boring and barren, the large yard featured just two trees and an old garden. "Not much was going on, and I wanted a lush, private space," he says, "I didn't want it to feel like you were in the city."

To make the yard more lively and livable, Lynn incorporated a swimming pool and a spacious patio for lounging. He also enlisted friend and landscape designer Jim Altum to designate perennials and other plantings that would create privacy and enhance the yard with color, texture, and scents from spring to fall. By carefully selecting plants with varied bloom periods, Altum ensured the yard would maintain visual interest throughout the seasons without becoming a monochromatic green.



HEAT-N-GLO

outdoor inspiration

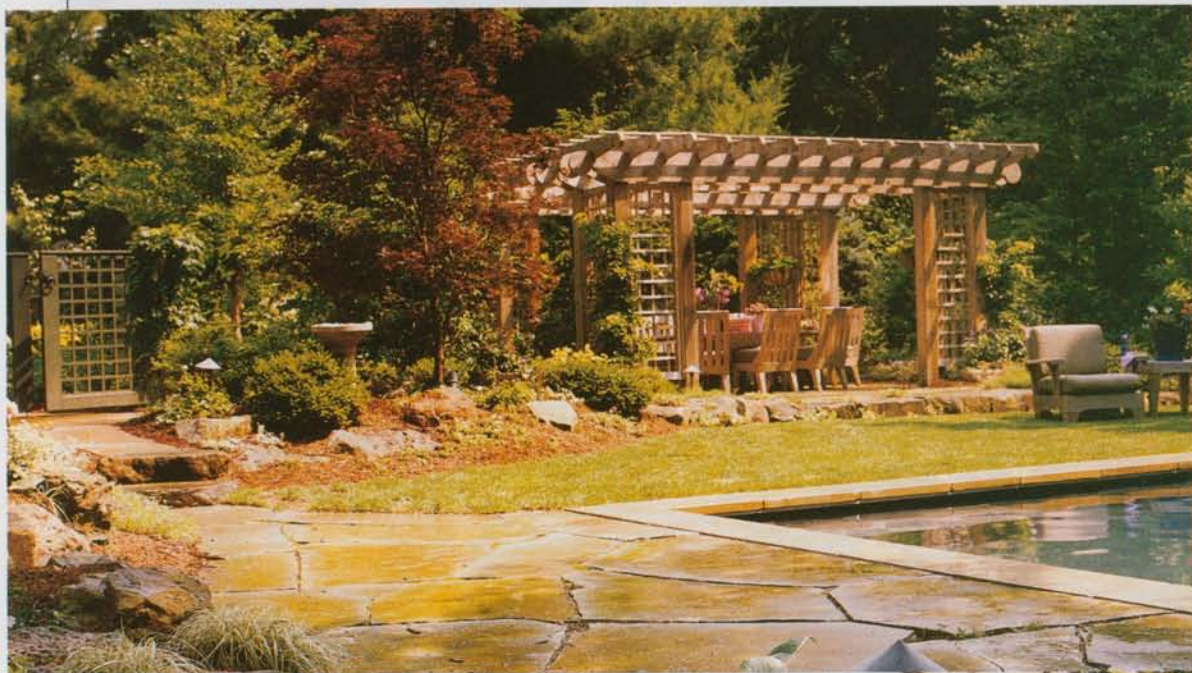

WRITER: Amanda Fier PHOTOGRAPHER: Jim Hedrich, Hedrich-Blessing
DESIGNER/BUILDER: Lynn Smith LANDSCAPE DESIGNER: Jim Altum FIELD EDITOR: Betsy Harris

Even with the pool and landscaping complete, Lynn felt the yard needed something more. He was standing on the patio after his first effort at improving the yard when the missing outdoor element came into focus. He grabbed a pen and napkin and sketched an image of what would become his dining pavilion.

"I would love to say there was a great deal of thought put into it, but I just have a tendency to do things spur of the moment," he says. "The quick and dirty sketch served as the architectural renderings for [the project]." The sketch was inspired by two outdoor living spaces: a dining area featured in a *New York Times* article and one designed by Altum for an Indianapolis flower and patio show.

Set against the lush greenery hemming the yard, the new dining pavilion ties together the house and landscape and provides a perfect dining and gathering spot. Lynn chose to build with cedar for its rustic appeal and easy maintenance, and because it matches his home's exterior. Under the sun or stars, the sleek, simple structure serves everyday and entertaining agendas throughout warmer months. "I enjoy it most at 5 or 5:30 in the morning," Lynn says, "when I take my dogs outside, with a cup of coffee and the newspaper." **RI**

FOR RESOURCES, SEE PAGE 122.



above: Lattice lends architectural interest to the pavilion's four supporting posts. Over time, foliage will fill in the structure's open spaces, creating a green ceiling to shade the dining table below.
top: Flowers, shrubs, and other plantings make the urban setting feel secluded. Flagstone paths connect the pool and patio to the dining pavilion.

The cedar dining pavilion was one of the final elements Lynn Smith used to transform his barren yard into a lush, private getaway.

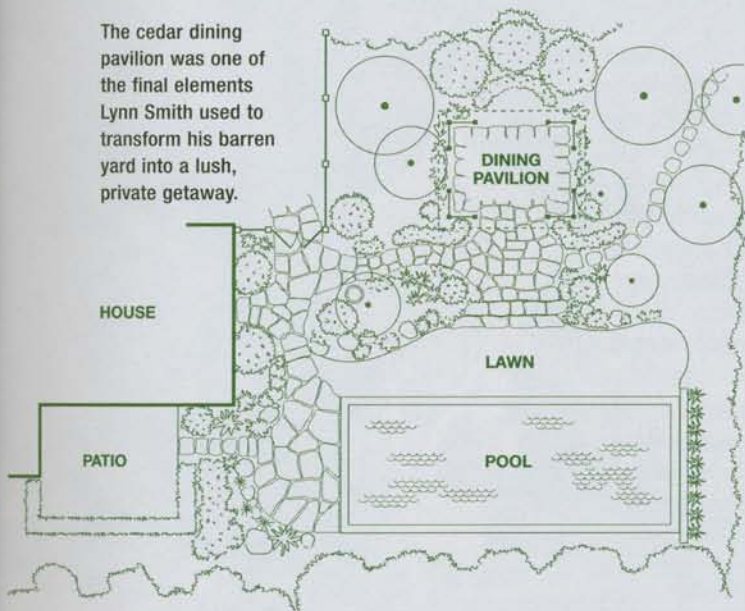

connect the spots

Seeking stylish inspiration for a backyard structure? Look at existing elements in your yard, or construct the outdoor living space to complement your home. Lynn Smith's pavilion features flagstone pavers that link the dining space to the pool and patio. The cedar used to construct the pavilion matches wood on the home's exterior.

To further integrate your structure with the landscape, select plants that provide complementary color, shape, or texture. Choose flowers, trees, and shrubs with staggered bloom times to keep your yard resplendent throughout the spring, summer, and fall.

Feel the Intensity™

Wrap yourself in the warm, passionate embrace of Intensity – the world's most realistic gas fireplace. Once you've experienced Intensity, you'll want it in every room. Fortunately, with Heat-N-Glo's patented Direct Vent Technology, you can have Intensity in spots other fireplaces only fantasize about. And with the distinction of its furnace rating and ducting capabilities, you'll feel Intensity even when you're in the next room. If you've never experienced Intensity, you really should.

INTENSITY™

HEAT-N-GLO®

No one builds a better fire

For FREE information, call 1-888-427-3973, visit www.heatnglo.com or www.fireplaces.com

